

## Illustrations from International Code Council publications

When 8-inch wood-to-earth separation is maintained sill plate is not required to be treated

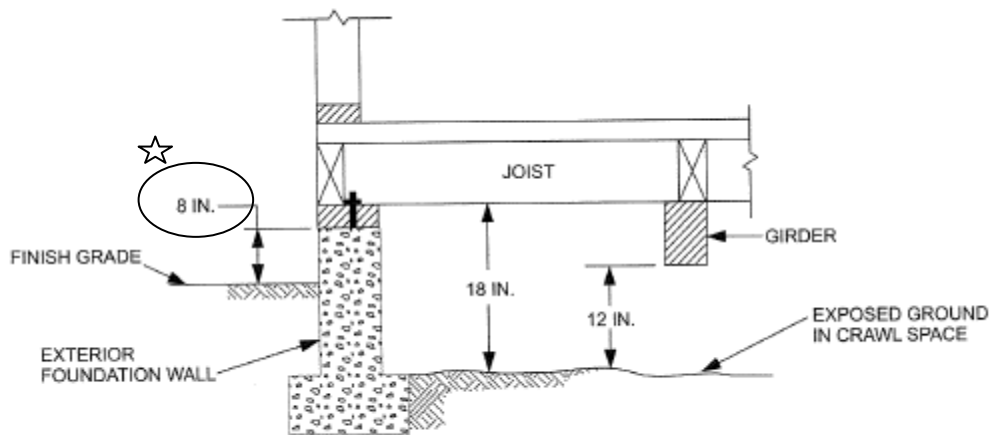

1 inch = 25.4 mm.

**Figure 2304.11.2.1  
WOOD-FRAMING CLEARANCES**

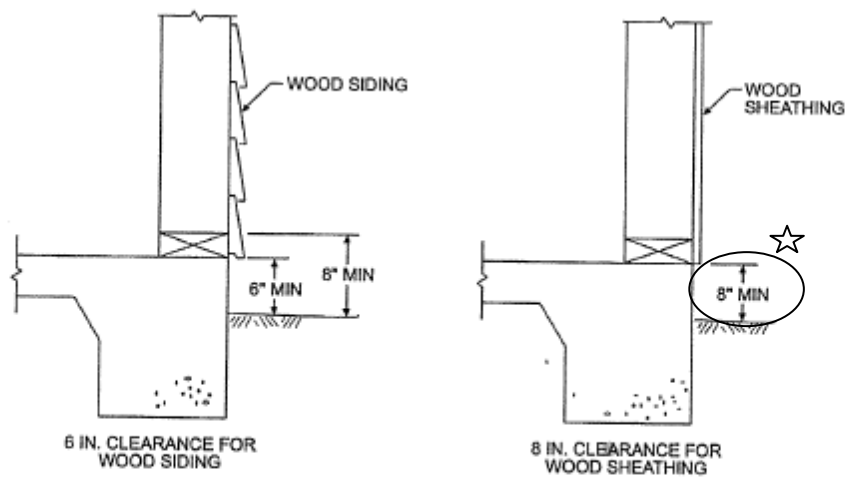

For SI: 1 inch = 25.4 mm.

**CLEARANCE FOR WOOD SIDING AND SHEATHING  
FIGURE 23-13**

The Orange Empire Chapter of ICC – Code Interpretation Committee has determined that the 8-inch wood-to-earth separation is not required where excessive exterior moisture and subterranean termites do not exist. [See additional sketches on the following page]